

## SLIDING SHOWER DOOR ENCLOSURES FITTING INSTRUCTIONS NS10, NS11, NS12

### IMPORTANT CHECK LIST

#### PLEASE ENSURE

- The walls are reasonable flat and that the shower tray is level
- There is no pipe work or cables behind walls where drilling
- Shower door is correct size door for tray(see measurements below)
- Shower base is level and secure and sealed correctly(bottom profile sealed on outside only)
- There is no visual defect on door(as claim will not be accepted after installation)
- Proper fixings used if cavity wall or other

TRAY Size	Dimensions A Min-Max
1000	970-995
1100	1070-1095
1200	1170-1195

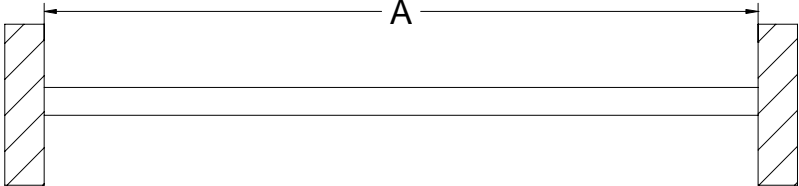

The diagram illustrates the measurement 'A' for the shower door enclosure. It shows two vertical hatched bars representing walls. A horizontal dimension line with arrows at both ends spans the distance between the inner faces of these two walls. The dimension line is labeled 'A' in the center.

## INSTRUCTION MANUAL

Inspect door after opening

Please read instructions carefully, check amount of accessories and whether the shower door is in good condition and if there are any problems contact your supplier or our company.

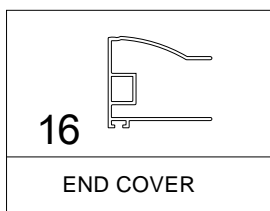
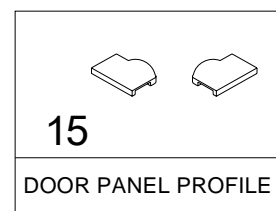
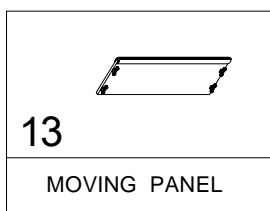
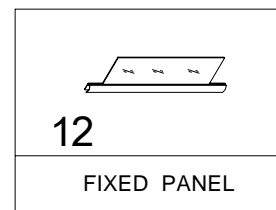
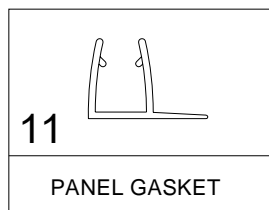
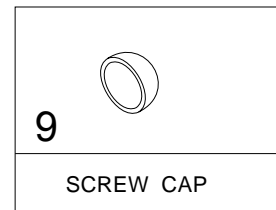
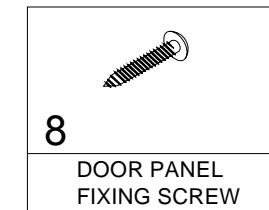
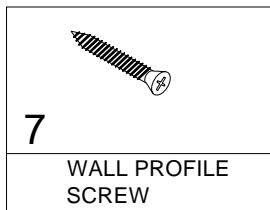
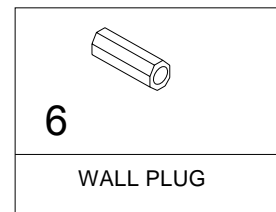
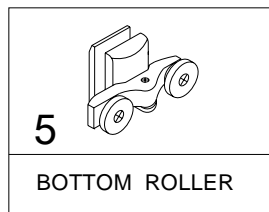
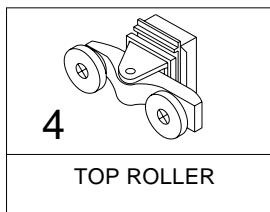
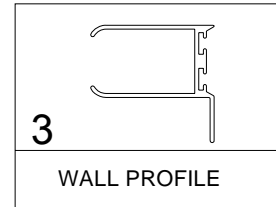
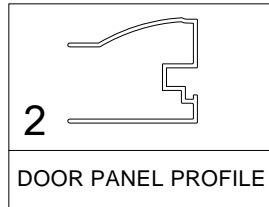
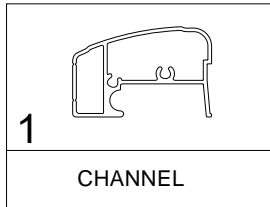

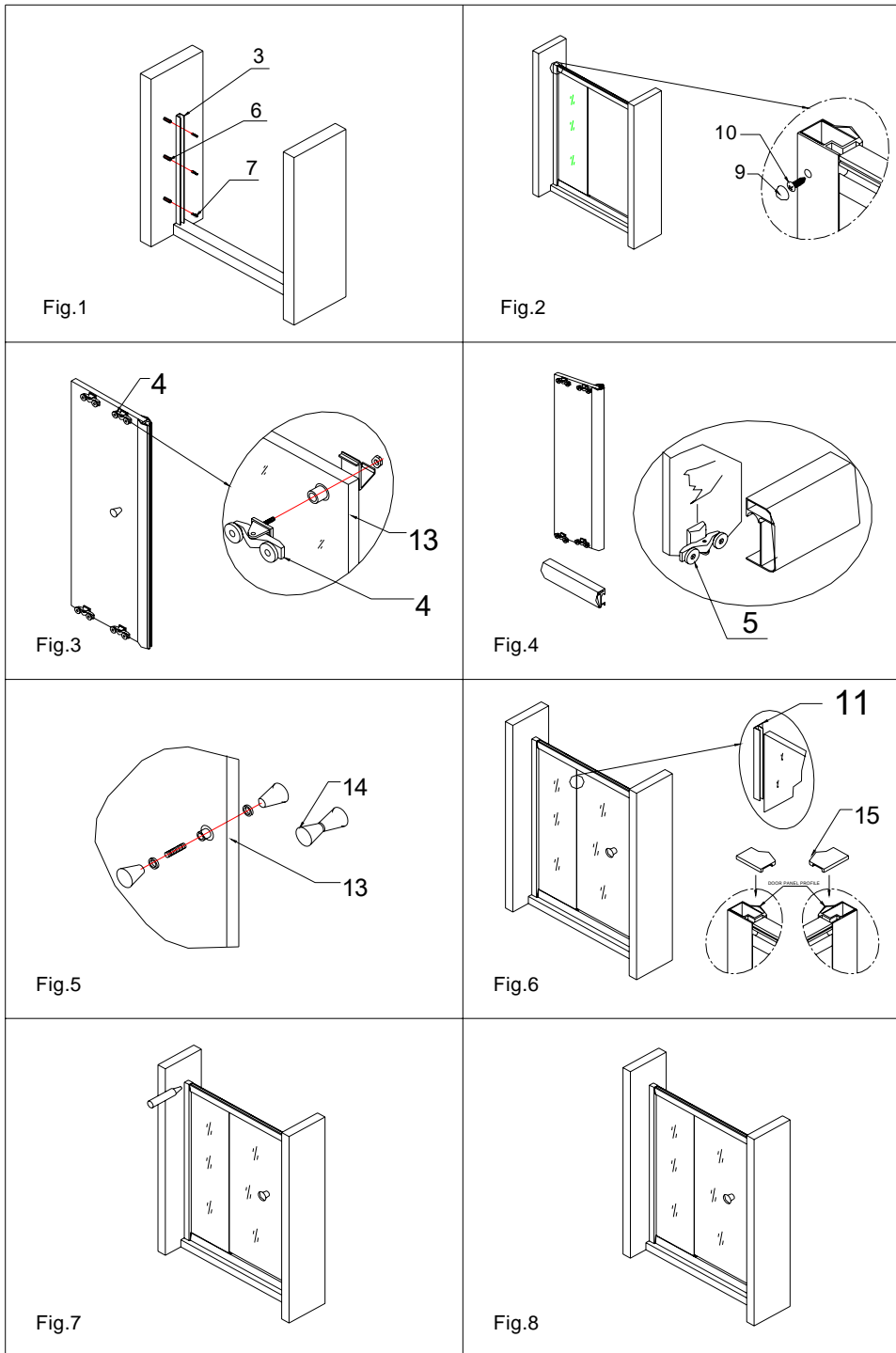

- 1、 Install wall profiles level in upright position using screws(see Fig.1)
- 2、 Level door on tray and fix door to wall profile as per(see Fig.2)
- 3、 Fix handles on to door. (see Fig 5)
- 4、 Adjust rollers if needed for smooth running

- 5、 Place silicone between wall profile and wall and between bottom profile and tray  
(outside only) do not use shower for 24hours

## Adjustment

All doors are designed to run correctly , If this does not occur please revert to adjusting rollers for smooth running

